

ORDINANCE NO. 5976

AN ORDINANCE relating to the King County Capital Budget and Program appropriating \$82,000 from the Park Acquisition and Development Unencumbered Fund Balance to the Enumclaw Fairgrounds Capital Improvement Project, increasing the 1982 Capital Improvement Budget and amending Ordinance No. 5757, Section 70, Attachment No. 1, as amended, and declaring an emergency.

BE IT ORDAINED BY THE COUNCIL OF KING COUNTY:

SECTION 1. There is hereby approved and adopted an appropriation in the amount of \$82,000 to the Park Acquisition and Development Fund from the unencumbered Fund Balance for the acquisition of land to provide additional parking at the King County Fairgrounds.

SECTION 2. Ordinance No. 5757, Section 70, as amended is hereby amended to read as follows:

Park Acquisition and Development

~~(\$2,900,967)~~ \$2,982,967

SECTION 3. Ordinance No. 5757, Section 70, Attachment No. 1, as amended is hereby revised as shown on the attached Capital Budget Resource Page.

1
2
3
4
5
6
7
8
9
10
11
12
13
14
15
16
17
18
19
20
21
22
23
24
25
26
27
28
29
30
31
32
33

1 Provided that:

2 Any acts made consistent with the authority and prior to the
3 effective date of this ordinance are hereby ratified and
4 confirmed.

5 SECTION 4. The County Council finds as a fact and declares
6 that an emergency exists and that this ordinance is necessary
7 for the immediate preservation of public peace, health or safety
8 or for the support of county government and its existing public
9 institutions.

10 INTRODUCED AND READ for the first time this May 3, 1982.

11 PASSED this 3rd day of May, 1982.

12 KING COUNTY COUNCIL
13 KING COUNTY, WASHINGTON

14
15 Lois North
Chairman

16 ATTEST:

17
18 Dorothy M. Owens
Deputy Clerk of the Council

19 APPROVED this 13th day of May, 19 82.

20
21 Randy Lowell
22 King County Executive

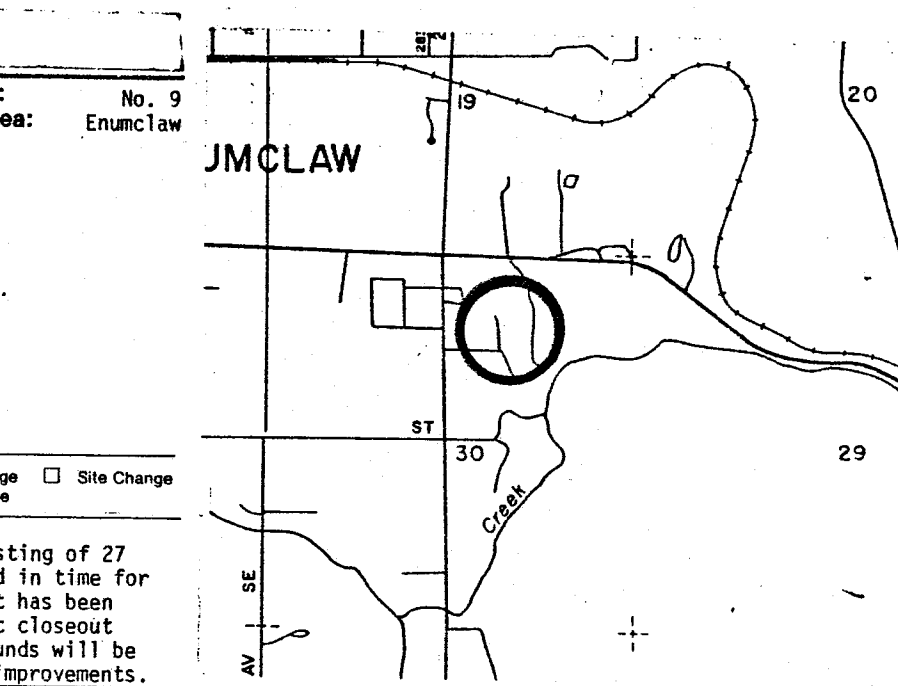

DEPARTMENT PRIORITY REQUEST 006 REVISED APRIL, 1982
 LOCATION - ENUMCLAW
 CURRENT PROJECT COST ESTIMATE 294,998
 EXPENDED & APPROPRIATED (INC RECOMMENDED) 294,998
 FUTURE FUNDING REQUIRED TO COMPLETE PROJECT 0

NET *PROGRAM PROJECTIONS - THOUSANDS OF DOLLARS* OPT/ACCOUNT
 PROGRAM TOTAL

EXP	1983	1984	1985	1986	1987	TOTAL
*						82,000
*						15,944
*						<u>197,054</u>
*						294,998

*						105,500
*						10,095
*						154,500
*						<u>24,903</u>
*						294,998
*						



Ordinance/Motion Title Acquisition of Land - Enumclaw Fairgrounds

Affected Agency/Agencies Parks Division

REVENUES IMPACT

Was revenue estimate included in current years budget N/A

Assumptions used in estimating revenue impact include:

EXPENDITURE IMPACT:

Was expenditure anticipated in current years budget No

Assumptions used in estimating expenditure include:

Assessment of land value by Real Property Division and negotiated purchase price.

IMPACT ON NON-COUNTY AGENCIES AND/OR INDIVIDUALS:

None.

Ordinance/Motion No. _____

5978 Title: Acquisition of Land - Enumclaw Fairgrounds

Affected Agency and/or Agencies Parks Division

Note Prepared by: Susan Clawson

Note Reviewed by: _____

Impact of the above legislation on the fiscal affairs of King County is estimated to be:

Revenue to:

Fund Title	Fund Code	Revenue Source	1st Year	2nd Year	3rd Year	4th Year
TOTAL						

Expenditures from:

Fund Title	Fund Code	Department	1st Year	2nd Year	3rd Year	4th Year
Park Acq. & Dev.	337	Parks	82,000	0	0	0
TOTAL			82,000	0	0	0

Expenditure by Categories	1st Year	2nd Year	3rd Year	4th Year
Salaries & Benefits				
Supplies & Services				
Capital Outlay	82,000	0	0	0
Other				
TOTAL	82,000	0	0	0